

GP8 GASOLINE PORTABLE VENTILATING BLOWER (USED STARTING W/SERIAL #28458)

REFERANCE NUMBER	PART NUMBER	DESCRIPTION	QUANTITY
1	133702	ENGINE, BRIGGS & STRATTON	REF
	GX120	ENGINE, HONDA	REF
2	GP8-0021	CASTING, REAR	1
3	GP8-0011	CASTING, FRONT	1
4	RV8	WHEEL, BLOWER	1
5	GP8-0042	SCREEN, INLET	1
6	GP8-0041	SCREEN, OUTLET	1
7	GP8-0030	HANDLE	1
8	GP8-0060	FRAME, MAIN	1
9	GP8-0070	SKID	2
10	503890	SPRING	4
11	GP8-0100	KEY	1
12	GP8-0080	SPACER, CRANKSHAFT	1
13	GP8-0090	SPACER, ENGINE	4
14	15051200	SCREW, CAP, 5/16 X 1 1/2" UNC, PLATED	4
15	17050000	WASHER, FLAT, 5/16", PLATED	16
16	18050000	NUT, HEX, 5/16 UNC, PLATED	6
17	27040600	SCREW, CAP, SOCKET, CS, 1/4" X 3/4" NC	4
18	60030500	SCREW, CAP, SOCKET, #10-24 X 5/8" UNC	4
19	33030000	WASHER, LOCK, #10, PLATED	4
20	18030000	NUT, HEX, #10-24 UNC, PLATED	4
21	15040700	SCREW, CAP, 1/4" X 7/8" UNC, PLATED	9
22	15050601	SCREW, CAP, 5/16" X 3/4" UNF, PLATED	1
23	16050000	WASHER, LOCK 5/16", PLATED	5
24	49050000	WASHER, FLAT, FENDER, 5/16", PLATED	1
25	30050400	SCREW, SET, OVAL POINT, 5/16" X 1/2" UNC	2
26	27051001	SCREW, CAP, SOCKET, CS, 5/16" X 1 1/4" NF	4
27	28050000	WASHER, LOCK, COUNTERSUNK, 5/16"	4
28	16040000	WASHER, LOCK, 1/4", PLATED	13
29	18040000	NUT, HEX, 1/4" UNC, PLATED	13
30	15050700	SCREW, CAP, 5/16" X 7/8" UNC, PLATED	2
31	GP8-5010	DECAL, GENERAL®, GP8	1
32	GP8-5020	PLATE, INFORMATION	1
33	GP8-5030	PLATE, FLOE RATES & SERIAL NUMBER	1
*	48020200	BRAD, DRIVE, 1/8" X 1/4" INFO. PLATE ATTACHING (NOT SHOWN)	8
*	999-7	VIDEO, SAFETY, VENTILATION BLOWER	1

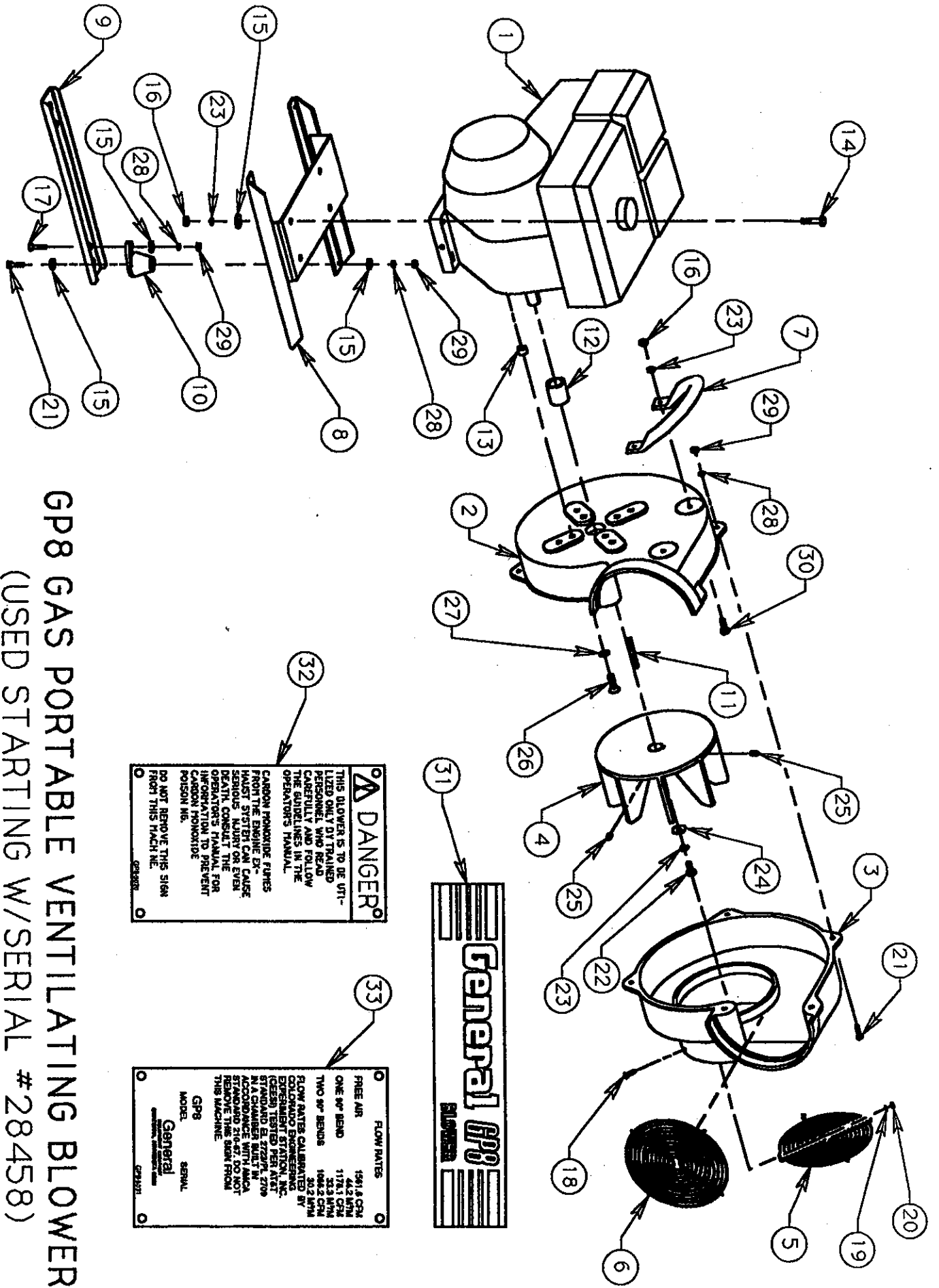

⚠ DANGER ⚠
 THIS BLOWER IS TO BE UTILIZED ONLY BY TRAINED PERSONNEL WHO READ CAREFULLY AND FOLLOW THE GUIDELINES IN THE OPERATOR'S MANUAL.
 CARBON MONOXIDE FUMES FROM THE ENGINE EXHAUST SHOULD BE KEPT FROM THE OPERATOR'S PLURAL FOR INFORMATION TO PREVENT CARBON MONOXIDE POISONING.
 DO NOT REMOVE THIS SIGN FROM THIS MACHINE.

FLOW RATES	
FREE AIR	1591.6 CFM
ONE 90° BEND	44.2 CFM
TWO 90° BENDS	1176.1 CFM
	33.3 CFM
	1686.2 CFM
	30.2 CFM
	1591.6 CFM

FLOW RATES CALIBRATED AT EXPENSIMET STATION, INC. (GREEN TESTED) PER A147 N.A. CHAMBER MULTI-METRA ACCORDING TO A147 DO NOT REMOVE THIS SIGN FROM THIS MACHINE.

GP8
 MODEL: SERIAL:
General
 GENERAL

GP8 GAS PORTABLE VENTILATING BLOWER
 (USED STARTING W/SERIAL #28458)

GP8 GAS PORTABLE VENTILATING BLOWER

REF.	Part Number	DESCRIPTION	QTY
1	GP8-0010	Casting, front	1
2	RV8	Wheel blower	1
3	GP8-0020	Casting, rear	1
4	GP8-0030	Handle	1
5	GP8-0040	Screen	2
6	GP8-0050	Banding, screen	2
7	GP8-0060	Frame, main	1
8	GP8-0070	Skid	2
9	GP8-0080	Spacer, crankshaft	1
10	GP8-0090	Spacer, engine	4
11	GP8-0100	Key	1
12	503890	Spring	4
13	440-5010	Decal, GENERAL	1
14	GP8-5020	Plate, information	1
15	GP8-5030	Plate flow rate & serial number	1
	4802020	Brads (not shown)	8
16	1504070	Screw, cap, 1/4" x 7/8" UNC, plated, grade 5	9
17	1604000	Washer, lock, 1/4" plated	13
18	1804000	Nut, hex, 1/4" plated	13
	3005040	Set screw (blower wheel)	1
19	2705100	Screw, cap, socket, countersunk, 5/16" x 1 1/4" HF	4
20	2805000	Washer, lock, countersunk, 5/16", plain finish	4
21	3703050	Machine screw, panhead, No. 10-24 x 3/8" long NC	8
22	3303000	Washer, lock, No. 10-24 plated	8
23	1803000	Nut, hex, 10-24, NC, plated	8
24	1505070	Screw, cap, 5/16" x 7/8" NC, plated, grade 5	2
	1505120	Motor mount screw, cap, 5/16" x 1 1/2" UNC, plated, grade 5 (Not shown)	4
	1705000	Washer, flat, 5/16" plated	4
25	1605000	Washer, lock, 5/16" plated	1
26	1805000	Nut, hex, 5/16" UNC, plated	6
27	1505060	Screw, cap, 5/16" x 3/4" long UNF, plated, grade 5	1
28	4905000	Washer, flat, fender, 5/16", plated	1
29	2704060	Screw, cap, socket, 1/4" x 3/4" long NC	4
30	1704000	Washer, flat, 1/4", plated	8

GP8 GAS PORTABLE VENTILATING BLOWER

General
13

▲ DANGER

THIS BLOWER IS TO BE UTILIZED ONLY BY TRAINED PERSONNEL WHO HAVE CAPACITY AND FOLLOW THE OPERATING INSTRUCTIONS. CARBON MONOXIDE FROM THE ENGINE EXHAUST SYSTEM CAN CAUSE SERIOUS INJURY OR EVEN DEATH. CONSULT THE OPERATOR'S MANUAL FOR INFORMATION TO PREVENT CARBON MONOXIDE POISONING.

DO NOT REMOVE THIS SIGN FROM THIS MACHINE.

FLOW RATES
FREE AIR 1503.9 CFM
26.5 M³/M
ONE 40 BEND 508.3 CFM
25.2 M³/M
TWO 40 BENDS 305.2 CFM
23.2 M³/M

FLOW RATES CALIBRATED BY COLORADO ENGINEERING EXPERIMENT STATION, INC. TESTS TESTED PER A.T. STANDARD 27.25 PL 2709 IN A CHAMBER BUILT IN ACCORDANCE WITH ASCA STANDARDS TO WHICH NOT BE FOR THIS SIGN FROM THIS MACHINE.

GP8

General

15

14

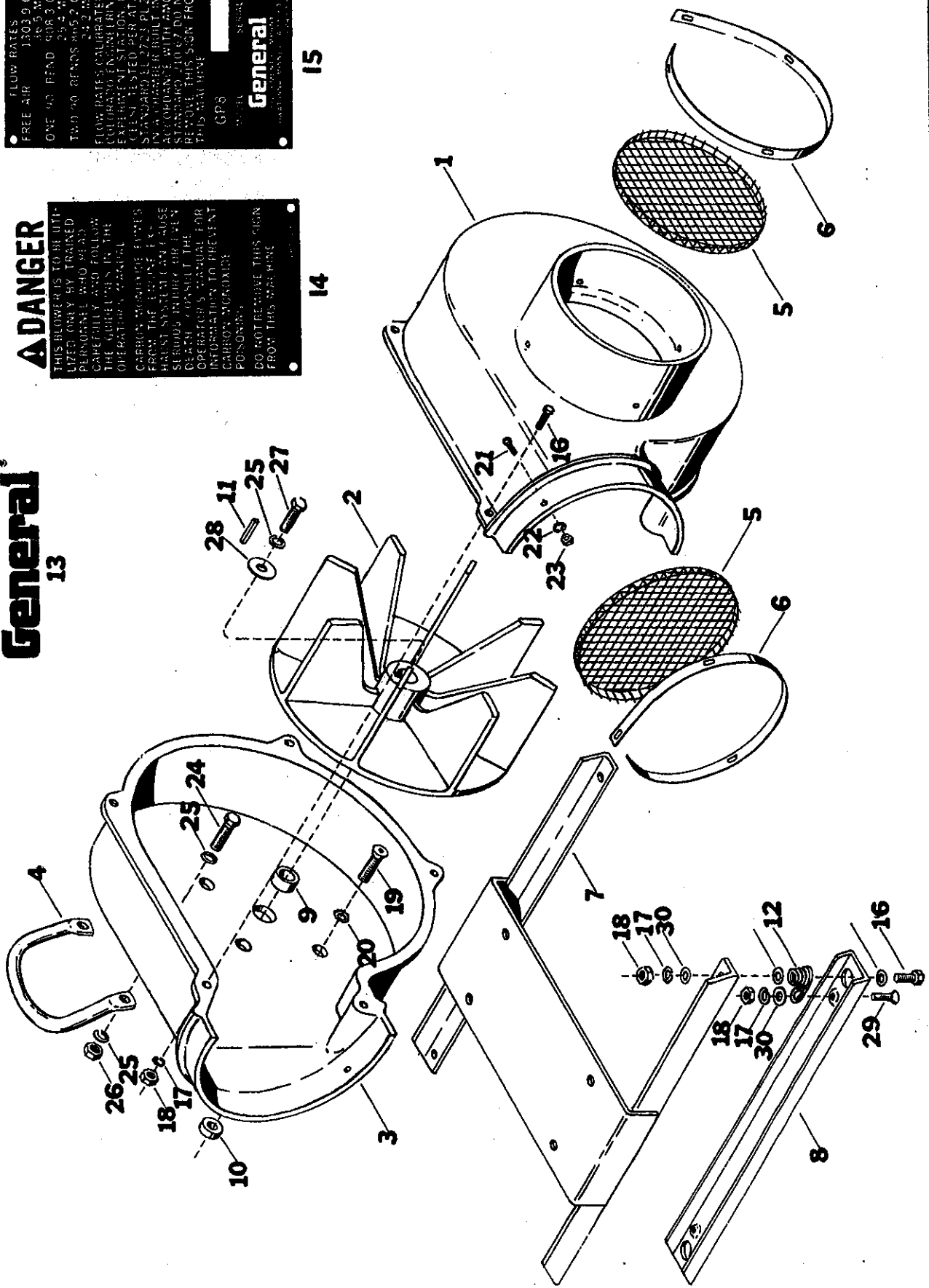

ATTACHMENTS AND OPTIONS FOR PORTABLE VENTILATING BLOWERS

REF	PART NUMBER	DESCRIPTION
1	FD810	8" (203 mm) Diameter x 10 foot (3 m) length Collapsible Duct with Anti-Scuff Strip and Securing Straps.
	FD815	8" (203 mm) Diameter x 15 foot (4.6 m) length Collapsible Duct with Anti-Scuff Strip and Securing Straps
	FD825	8" (203 mm) Diameter x 25 feet (7.6 m) length Collapsible Duct with Anti-Scuff Strip and Securing Straps
2	SC815	Storage Cannister for FD810 and FD815 Collapsible Ducts Lockable Cover.
	SC825	Storage Cannister for FD825 Collapsible Duct. Lockable Cover.
3	SR815	Storage Rack for FD810 and FD815 Collapsible Duct.
	SR825	Storage Rack for FD825 Collapsible Duct.

