

# EP8 ELECTRIC PORTABLE VENTILATING BLOWER

(USED THRU SERIAL #27748)

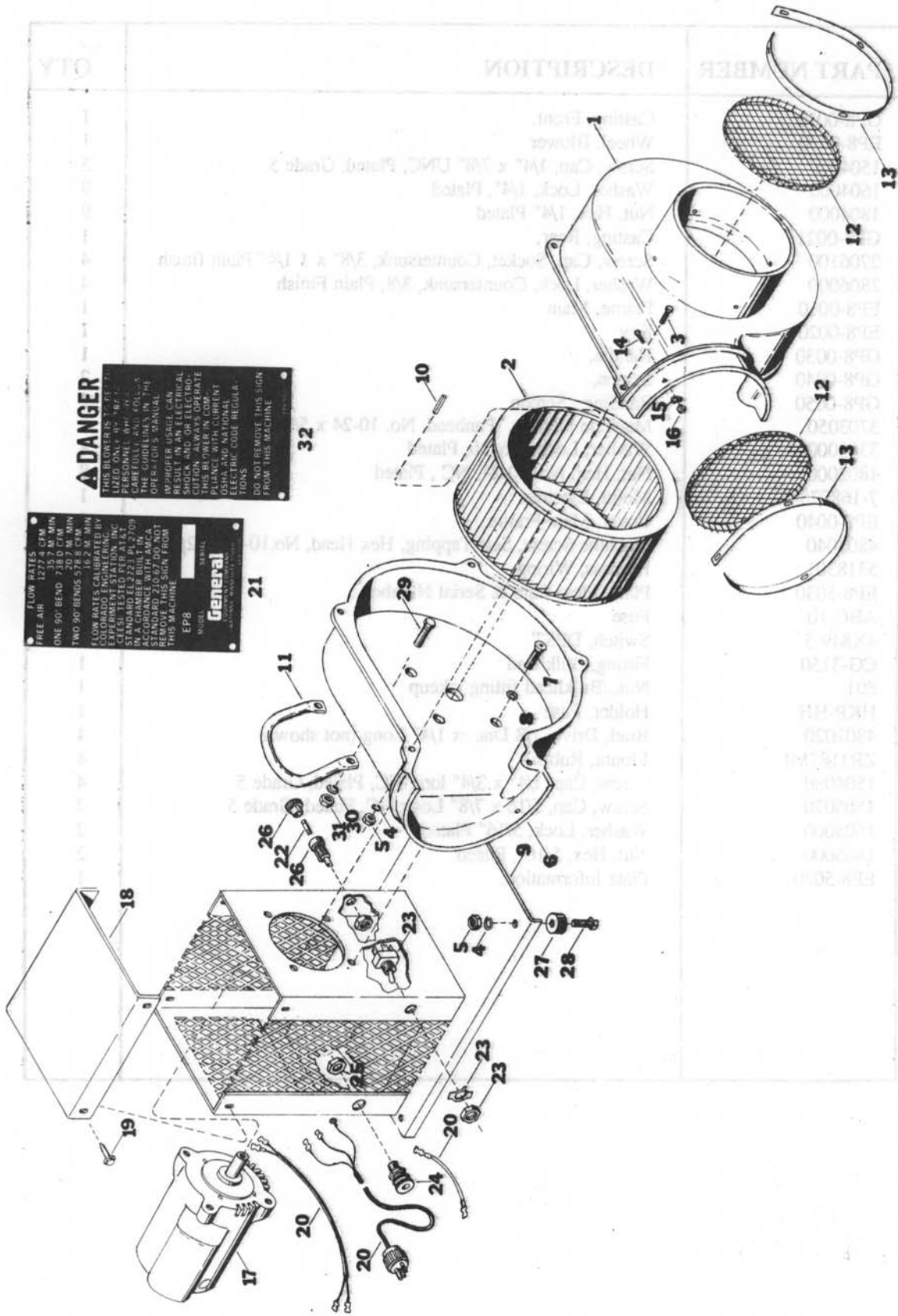

**FLOW RATES**  
 FREE AIR 1277.4 CFM  
 ONE 90° BEND 735.7 M. MIN.  
 TWO 90° BENDS 578.8 CFM  
 FLOW RATES CALCULATED BY  
 COLORADO ENGINEERING, INC.  
 IN A CHAMBER BUILT IN  
 STANDARD I.L. 2 1/2' R.T.S.  
 STANDARD I.L. WITH A.V.C.A.  
 REMOVE THIS SIGN FROM  
 THIS MACHINE

**⚠ DANGER**  
 THIS BLOWER IS NOT TO BE  
 OPERATED BY UNTRAINED  
 PERSONNEL WHO DO NOT  
 CAREFULLY READ AND  
 UNDERSTAND THE  
 OPERATOR'S MANUAL.  
 IMPROPER USE CAN  
 RESULT IN AN ELECTRICAL  
 SHOCK AND OR ELECTRICAL  
 FIRE. ALWAYS OPERATE  
 THIS BLOWER IN ACCORDANCE  
 WITH ALL CURRENT  
 OSHA AND NATIONAL  
 ELECTRICAL CODE REGULATIONS.  
 DO NOT REMOVE THIS SIGN  
 FROM THIS MACHINE.

EP8 ELECTRIC PORTABLE VENTILATING BLOWER  
 (USED THRU SERIAL #27748)

QTY	DESCRIPTION	PART NUMBER
-----	-------------	-------------

# EP8 ELECTRIC PORTABLE VENTILATING BLOWER

(USED THRU SERIAL #27748)

REF	PART NUMBER	DESCRIPTION	QTY
1	GP8-0010	Casting, Front,	1
2	EP8-0030	Wheel, Blower	1
3	1504070	Screw, Cap, 1/4" x 7/8" UNC, Plated, Grade 5	5
4	1604000	Washer, Lock, 1/4", Plated	9
5	1804000	Nut, Hex, 1/4" Plated	9
6	GP8-0021	Casting, Rear,	1
7	2706100	Screw, Cap, Socket, Countersunk, 3/8" x 1 1/4" Plain finish	4
8	2806000	Washer, Lock, Countersunk, 3/8, Plain Finish	4
9	EP8-0010	Frame, Main	1
10	EP8-0020	Key	1
11	GP8-0030	Handle,	1
12	GP8-0040	Screen,	2
13	GP8-0050	Banding , Screen	2
14	3703050	Machine , Screw, Panhead, No. 10-24 x 5/8" Long NC Plated	8
15	3303000	Washer, Lock, No. 10, Plated	8
16	1803000	Nut, Hex, No. 10-24, NC , Plated	8
17	7-168075-20	Motor, Electric	1
18	EP8-0040	Cover, Main Frame	1
19	4803040	Machine Screw, Self Tapping, Hex Head, No.10-24x1/2plated	4
20	5318301	Harness, Wiring	1
21	EP8-5030	Plate, Flow Rate & Serial Number	1
22	ABC-10	Fuse	1
23	4X849-5	Switch, DPST	1
24	CG-3150	Fitting, Bulkhead	1
25	801	Nut, /Bulkhead fitting takeup	1
26	HKP-HH 4802020	Holder, Fuse Brad, Drive, 1/8 Dia. x 1/4" Long (not shown)	1 4
27	ZB1187MI	Mount, Rubber	4
28	1504080	Screw, Cap, 1/4" x 3/4" long NC, Plated, Grade 5	4
29	1505070	Screw, Cap, 5/16 x 7/8" Long NC, Plated, Grade 5	2
30	1605000	Washer, Lock, 5/16" Plated	2
31	1805000	Nut, Hex, 5/16", Plated	2
32	EP8-5020	Plate Information	1

# EP8 ELECTRIC PORTABLE VENTILATING BLOWER (USED STARTING W/SERIAL #27749)

REFERANCE NUMBER	PART NUMBER	DESCRIPTION	QUANTITY
1	GP8-0011	CASTING, FRONT	1
2	EP8-0030	WHEEL, BLOWER	1
3	15040700	SCREW, CAP 1/4 X 7/8" UNC, PLATED, GR 5	5
4	16040000	WASHER, LOCK 1/4", PLATED	9
5	18040000	NUT, HEX, 1/4 UNC, PLATED	10
6	GP8-0021	CASTING, REAR	1
7	27061000	SCREW, CAP, SOCKET C/S, 3/8 X 1 1/4" UNC	4
8	28060000	WASHER, LOCK, C/S 3/8"	4
9	EP8-0010	FRAME, MAIN	1
10	EP8-0020	KEY	1
11	GP8-0030	HANDLE	1
12	GP8-0042	SCREEN, INLET	1
13	GP8-0041	SCREEN, OUTLET	1
14	60030500	SCREW, CAP SOCKET #10-24 X 5/8" UNC	4
15	33030000	WASHER, LOCK, #10, PLATED	4
16	18030000	NUT, HEX, #10-24 UNC, PLATED	4
17	7-168075-20	MOTOR, ELECTRIC	1
18	EP8-0040	COVER, MAIN FRAME	1
19	48030400	SCREW, MACHINE, SELF TAP, #10-24 X 1/2"	5
20	EP8-0061	WIRE, FUSE	1
21	EP8-5030	PLATE, FLOW RATE	1
22	ABC-10	FUSE	1
23	4X849-5	SWITCH, DPST	1
24	CG-3150	FITTING, BULKHEAD	1
25	801	NUT, BULKHEAD FITTING TAKEUP	1
26	HKP-HH	HOLDER, FUSE	1
27	ZB1187MI	MOUNT, RUBBER	4
28	15040800	SCREW, CAP, 1/4 X 3/4" UNC, PLATED, GR 5	4
29	15050700	SCREW, CAP, 5/16 X 7/8" UNC, PLATED, GR 5	2
30	16050000	WASHER, LOCK, 5/16, PLATED	2
31	18050000	NUT, HEX, 5/16 UNC, PLATED	1
32	EP8-5020	PLATE, INFORMATION	1
33	EP8-5040	DECAL, WARNING	1
34	EP8-5010	DECAL, GENERAL®, BLOWER	1
35	EP8-0080	GUARD, SWITCH	1
36	57040000	WASHER, INTERNAL TOOTH LOCK	1
37	EP8-0051	WIRE, CORD WITH PLUG	1
38	EP8-0071	WIRE, SWITCH TO MOTOR	1
*	48020200	BRAD, DRIVE, 1/8" X 1/4" INFO. PLATE ATTACHING (NOT SHOWN)	8
*	999-7	VIDEO, SAFETY, VENTILATION BLOWER	1

# EP8 ELECTRIC PORTABLE VENTILATING BLOWER

(USED STARTING W/SERIAL #27749)

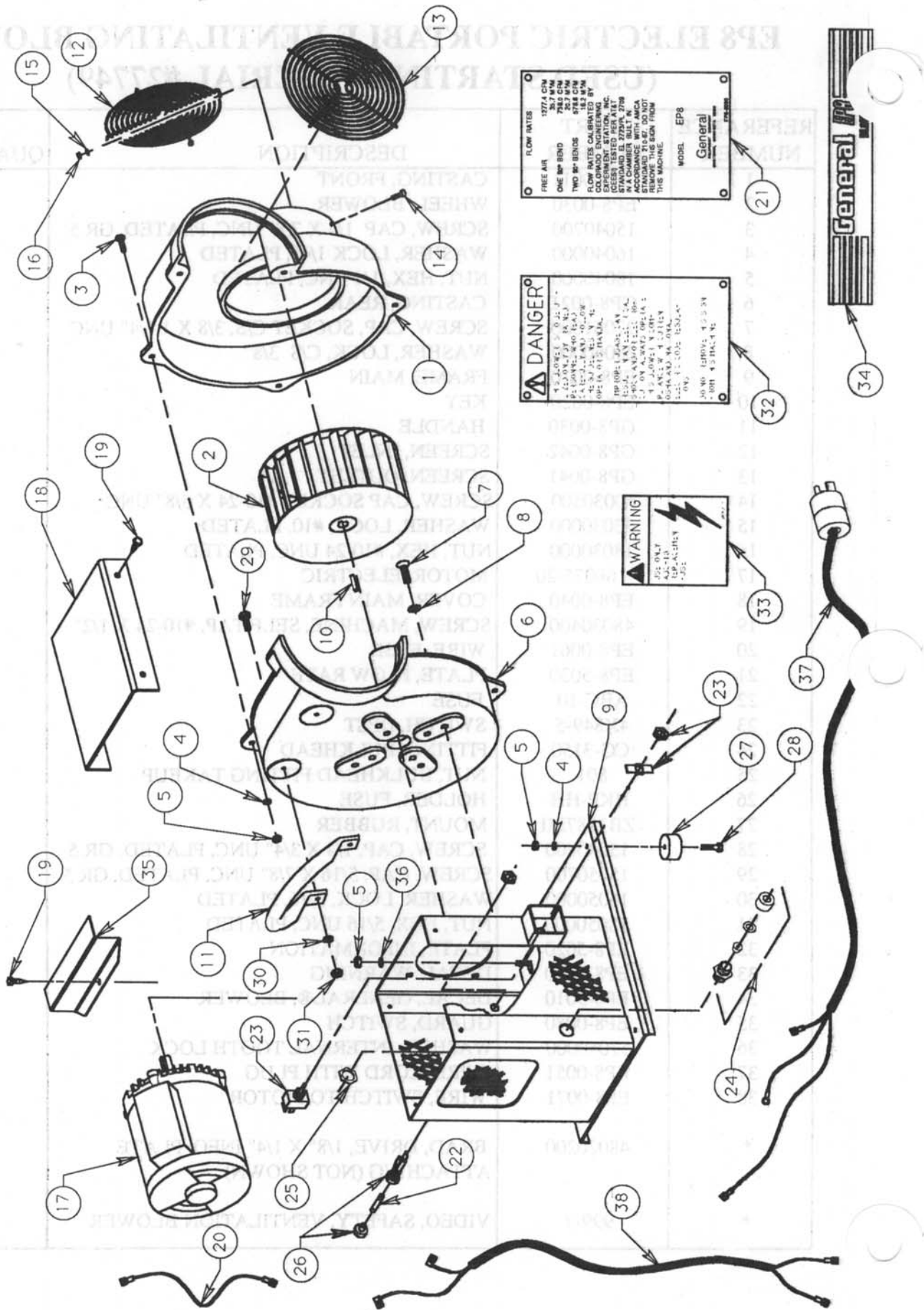

FLOW RATES	12774 CFM
FREE AIR	35.7 MPM
ONE 1/2" BEND	28.8 MPM
TWO 1/2" BENDS	22.7 MPM
THREE 1/2" BENDS	18.5 MPM
FOUR 1/2" BENDS	14.3 MPM
FIVE 1/2" BENDS	10.1 MPM
SIX 1/2" BENDS	5.9 MPM

FLOW RATES CALIBRATED BY  
COLUMBIA ENGINEERING  
STANDARD 81.2725A, 2788  
ACCORDANCE WITH AMCA  
STANDARD 21.67. DO NOT  
EXCEED. ALWAYS BEGIN FROM  
THIS MACHINE.

MODEL EP8  
General  
EPA-2000

DANGER	
4.5-10.96V	0.25A
4.2-10.8V	0.25A
4.0-10.7V	0.25A
3.8-10.6V	0.25A
3.6-10.5V	0.25A
3.4-10.4V	0.25A
3.2-10.3V	0.25A
3.0-10.2V	0.25A
2.8-10.1V	0.25A
2.6-10.0V	0.25A
2.4-9.9V	0.25A
2.2-9.8V	0.25A
2.0-9.7V	0.25A
1.8-9.6V	0.25A
1.6-9.5V	0.25A
1.4-9.4V	0.25A
1.2-9.3V	0.25A
1.0-9.2V	0.25A
0.8-9.1V	0.25A
0.6-9.0V	0.25A
0.4-8.9V	0.25A
0.2-8.8V	0.25A
0.0-8.7V	0.25A
0.0-8.6V	0.25A
0.0-8.5V	0.25A
0.0-8.4V	0.25A
0.0-8.3V	0.25A
0.0-8.2V	0.25A
0.0-8.1V	0.25A
0.0-8.0V	0.25A
0.0-7.9V	0.25A
0.0-7.8V	0.25A
0.0-7.7V	0.25A
0.0-7.6V	0.25A
0.0-7.5V	0.25A
0.0-7.4V	0.25A
0.0-7.3V	0.25A
0.0-7.2V	0.25A
0.0-7.1V	0.25A
0.0-7.0V	0.25A
0.0-6.9V	0.25A
0.0-6.8V	0.25A
0.0-6.7V	0.25A
0.0-6.6V	0.25A
0.0-6.5V	0.25A
0.0-6.4V	0.25A
0.0-6.3V	0.25A
0.0-6.2V	0.25A
0.0-6.1V	0.25A
0.0-6.0V	0.25A
0.0-5.9V	0.25A
0.0-5.8V	0.25A
0.0-5.7V	0.25A
0.0-5.6V	0.25A
0.0-5.5V	0.25A
0.0-5.4V	0.25A
0.0-5.3V	0.25A
0.0-5.2V	0.25A
0.0-5.1V	0.25A
0.0-5.0V	0.25A
0.0-4.9V	0.25A
0.0-4.8V	0.25A
0.0-4.7V	0.25A
0.0-4.6V	0.25A
0.0-4.5V	0.25A
0.0-4.4V	0.25A
0.0-4.3V	0.25A
0.0-4.2V	0.25A
0.0-4.1V	0.25A
0.0-4.0V	0.25A
0.0-3.9V	0.25A
0.0-3.8V	0.25A
0.0-3.7V	0.25A
0.0-3.6V	0.25A
0.0-3.5V	0.25A
0.0-3.4V	0.25A
0.0-3.3V	0.25A
0.0-3.2V	0.25A
0.0-3.1V	0.25A
0.0-3.0V	0.25A
0.0-2.9V	0.25A
0.0-2.8V	0.25A
0.0-2.7V	0.25A
0.0-2.6V	0.25A
0.0-2.5V	0.25A
0.0-2.4V	0.25A
0.0-2.3V	0.25A
0.0-2.2V	0.25A
0.0-2.1V	0.25A
0.0-2.0V	0.25A
0.0-1.9V	0.25A
0.0-1.8V	0.25A
0.0-1.7V	0.25A
0.0-1.6V	0.25A
0.0-1.5V	0.25A
0.0-1.4V	0.25A
0.0-1.3V	0.25A
0.0-1.2V	0.25A
0.0-1.1V	0.25A
0.0-1.0V	0.25A
0.0-0.9V	0.25A
0.0-0.8V	0.25A
0.0-0.7V	0.25A
0.0-0.6V	0.25A
0.0-0.5V	0.25A
0.0-0.4V	0.25A
0.0-0.3V	0.25A
0.0-0.2V	0.25A
0.0-0.1V	0.25A
0.0-0.0V	0.25A

**WARNING**

DO NOT  
USE  
FOR  
OTHER  
PURPOSES



## ATTACHMENTS AND OPTIONS FOR PORTABLE VENTILATING BLOWERS

REF	PART NUMBER	DESCRIPTION
1	FD810	8" (203 mm) Diameter x 10 foot (3 m) length Collapsible Duct with Anti-Scuff Strip and Securing Straps.
	FD815	8" (203 mm) Diameter x 15 foot (4.6 m) length Collapsible Duct with Anti-Scuff Strip and Securing Straps
	FD825	8" (203 mm) Diameter x 25 feet (7.6 m) length Collapsible Duct with Anti-Scuff Strip and Securing Straps
2	SC815	Storage Cannister for FD810 and FD815 Collapsible Ducts Lockable Cover.
	SC825	Storage Cannister for FD825 Collapsible Duct. Lockable Cover.
3	SR815	Storage Rack for FD810 and FD815 Collapsible Duct.
	SR825	Storage Rack for FD825 Collapsible Duct.

